

**SECOND FLOOR - ALL WORK  
GENERAL NOTES**

1. REFER TO THIS DRAWING FOR DIMENSIONS, DOOR NUMBERS, ETC. WHICH DESCRIBE THE SCOPE OF WORK AT THE SECOND FLOOR AND COURTYARD ROOF.
2. ALL CONDITIONS SHOWN ON THIS DRAWINGS SHALL BE CONSIDERED AS EXISTING AND SHALL REMAIN AS IS, UNLESS OTHERWISE NOTED.
3. IT IS THE DESIGN INTENT TO UTILIZE EXIST. ROOF OPENINGS TO SUPPORT EXHAUST VENTS AND HOODS AS REQUIRED TO ACCOMMODATE NEW MECHANICAL WORK (AS NOTED ON THE DRAWINGS), WITHOUT THE REQUIREMENT OF MODIFYING THE EXIST. ROOF MEMBRANE.

**KEYED PLAN NOTES**

- (A) ITEMS SHADED THUSLY INDICATE EXISTING 2 FT. X 4 FT. SKYLIGHTS, MOUNTED ON RAISED CURBS, ON EXISTING RAISED PLATFORM.
- (B) EXTENT OF EXISTING RAISED PLATFORM.
- (C) EXIST. EMERGENCY EGRESS FROM EXIST. STAIR B SEE SHEET DA-1 FOR RELATED COMMENTS.
- (D) EXIST. EMERGENCY EGRESS FROM EXIST. STAIR D SEE SHEET DA-1 FOR RELATED COMMENTS.
- (E) EXIST. ACCESS FROM STAIR B TO GARAGE ROOF.
- (F) EXIST. ACCESS FROM STAIR D TO GARAGE ROOF.
- (G) EXIST. "MUSHROOM" TYPE EXHAUST FAN. MECH. SUBCONTRACTOR TO VERIFY IF UNIT CAN BE RE-USED FOR NEW WORK. IF NOT, REMOVE AND REPLACE EXIST. UNIT WITH NEW UNIT AS NEEDED TO ACCOMMODATE EXHAUST REQUIREMENTS OF NEW LAUNDRY ROOM AND JANITOR'S CLOSET. (IT IS THE DESIGN INTENT THAT THE UNIT BE WIRED TO THE LIGHT SWITCH IN THE LAUNDRY ROOM TO SWITCH "ON" WHEN THE LIGHT IS SWITCHED "ON". SEE REFLECTED CEILING PLAN, SHEET A-6 FOR RELATED COMMENTS.)
- (H) EXIST. METAL "MOOSE HORN" VENT HOOD. MECH. SUBCONTRACTOR TO FIELD VERIFY IF UNIT CAN BE UTILIZED TO HOUSE VENTS FROM NEW DRINKERS. REMOVE OR REPLACE WITH NEW AS REQUIRED.

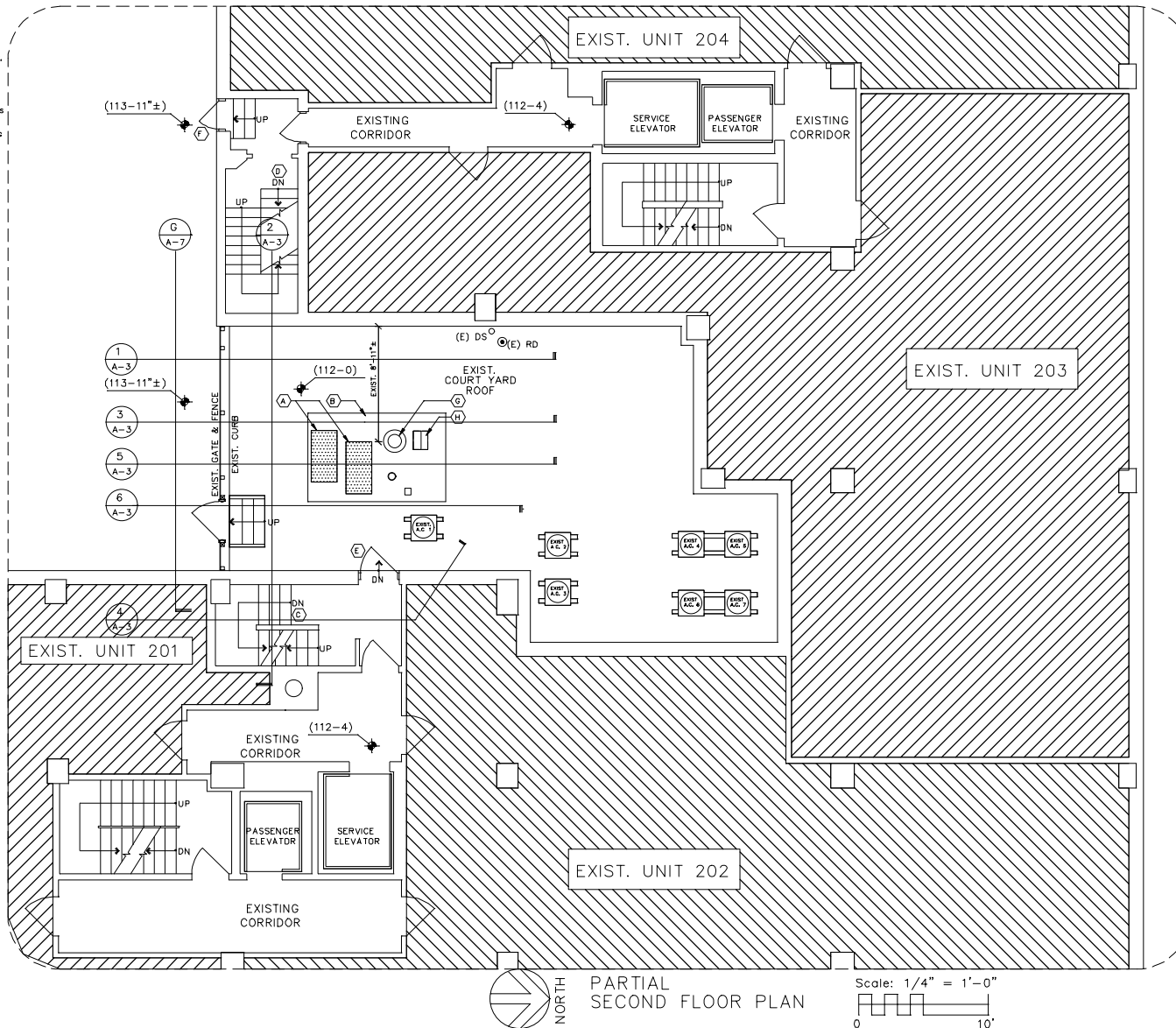

ARCHITECT  
ROBERT BRAUCH  
REGISTERED ARCHITECT  
STATE OF MISSOURI  
LICENSE NO. - 480488

ARCHITECT  
ROBERT BRAUCH  
4960 NEEDS  
ST. LOUIS, MO 63109  
(314) 481-1920

CORRIDOR MODIFICATIONS  
VERSAILLES CONDOS  
701 SKINKER AVE.  
ST. LOUIS, MO 63112

Date Issued: 01/31/14  
Addendum:  
#1 02/28/14  
#2 03/03/14  
#3 05/29/14

SHEET NO.

A-2

Page 7 of 13